

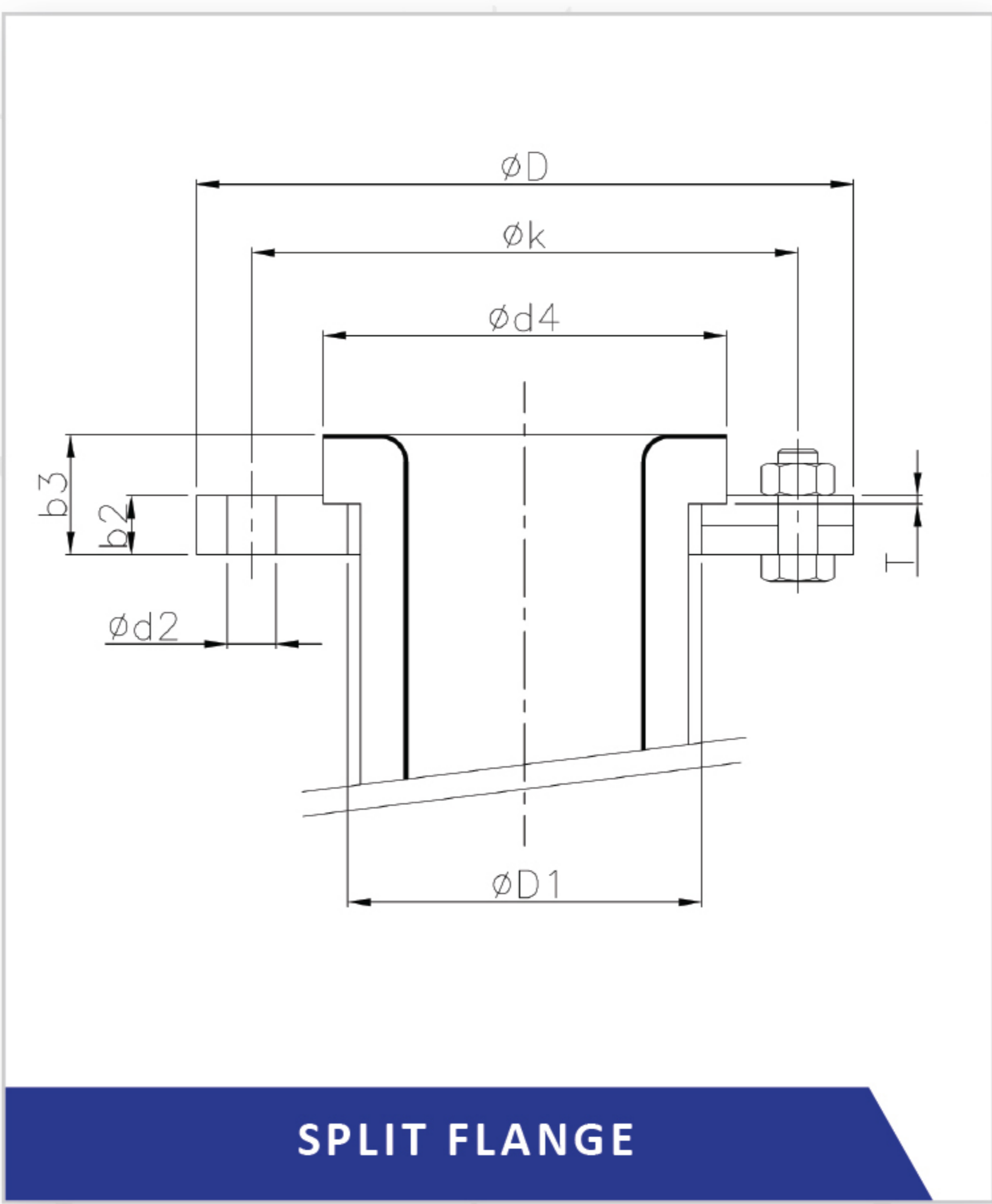

# SPLIT FLANGE



**SPLIT FLANGE**

**\*METRIC TABLE**

DN	PN	D	D1	d4	k	d2	b2	b3	T	daN	Weight 2xLoose flange+bolt
20	40	105	44	69	75	4xØ14	18	25	2	1	2
25	16	115	48	69	85	4xØ14	14	25	2	0.8	2.1
32	16	140	60	79	100	4xØ18	14	25	2	1.2	3.3
40	16	150	66	89	110	4xØ18	14	25	2	1.4	3.7
50	16	165	80	103	125	4xØ18	16	29	2	1.9	4.7
65	16	185	94	123	145	4xØ18	17	30	2	2.4	5.7
80	16	200	114	139	160	4xØ18	18	32	2	2.6	7.1
100	16	220	136	159	180	4xØ18	20	35	2	3.3	8.5
125	16	250	162	188	210	4xØ18	22	38	3	4.3	10.6
150	16	285	188	215	240	8xØ22	25	41	3	6.2	15.9
200	10	340	238	270	295	8xØ22	28	46	3	9.1	21.9
250	10	395	294	323	350	12xØ22	32	52	3	12.1	30.4
300	10	445	344	371	400	12xØ22	34	56	3	15	36.2
350	10	505	396	431	460	16xØ22	36	60	3	19.4	47.4
400	10	565	446	483	515	16xØ27	40	64	3	25.9	66.4